

# SEM7800 Series

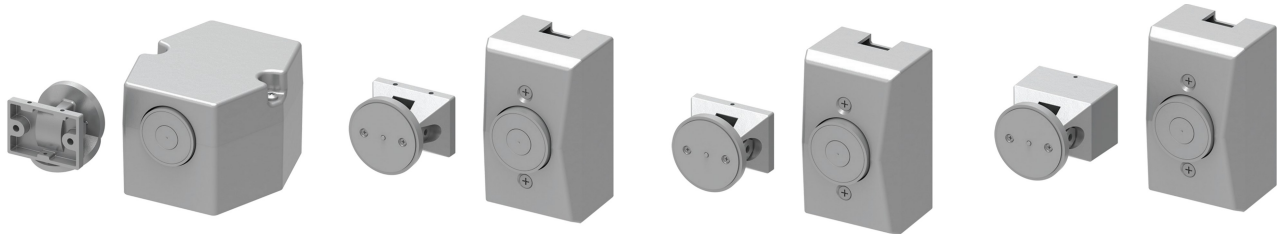

The Sentronic® SEM 7800 Series are heavy duty, electrically controlled door holding magnets. Magnets are fail safe and hold until the current is interrupted. A manual door closer is used to control and close the door. A choice of floor, recessed wall, or surface mounted wall magnets are available.

## Features

Certifications	Grade 1 – ANSI A156.15, UL 10C for metal smoke barrier or labeled door, Life Safety Code, NFPA 101, 100 Hour Salt Spray, Meets BAA – Buy American Act
Voltage	Tri-voltage design with 35 lbs. of holding force
Housing	Die cast
Fasteners	Wood and Machine Screws (WMS)
Finishes/colors/powder coat	<ul style="list-style-type: none"><li>689 Aluminum paint</li><li>695 Dark Bronze paint</li></ul>
Options	Available with armature extensions (see <a href="#">page 10</a> )

## Electrical data

### Voltage input

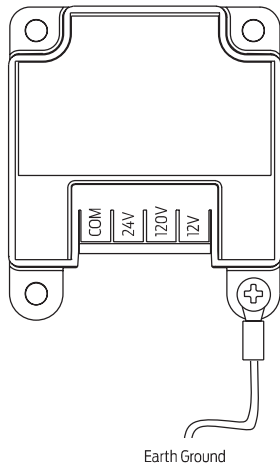

### Electrical schematic

**Operation:**  
Electromagnets are typically used with fire alarm systems. Doors are held open in the non-alarm condition. When the fire alarm panel enters the alarm condition, power to the electromagnets is removed, the doors close under door closer control, and function as a manual door. When the fire alarm panel returns to the non-alarm condition, power is reapplied to the electromagnets and the doors can be held open again.

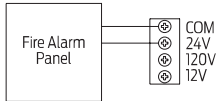

Fig. 1 24V AC/DC Wiring  
Polarity is inimportant

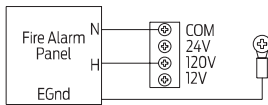

Fig. 2 120V AC Wiring

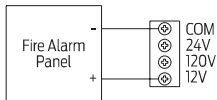

Fig. 3 12V DC Wiring  
Polarity as shown

Electrical Specifications  
Max. Current Draw  
.030A @ 12VDC  
.020A @ 24VAC/DC  
.020A @ 120VAC

Holding force	35 lbs. @ nominal input voltage
Maximum current draw	<ul style="list-style-type: none"><li>Standard profile recessed wall mount</li><li>2" (51 mm) x 4" (102 mm) x 1 1/2" (38 mm)</li></ul>

Mounting details

7820

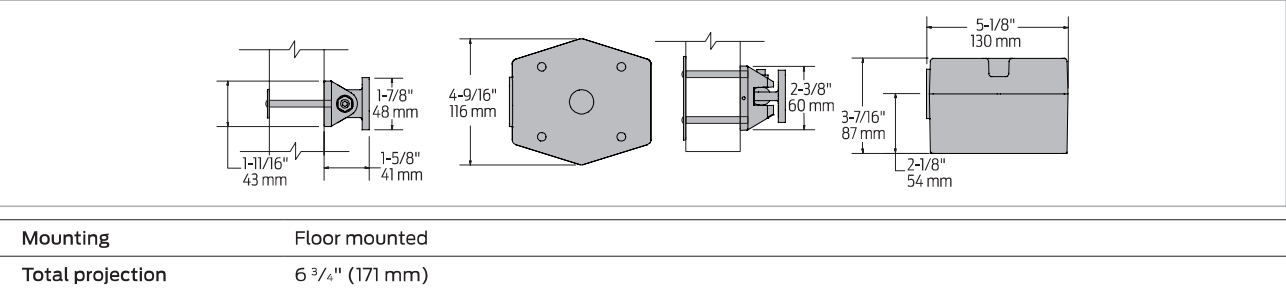

7830<sup>1</sup>

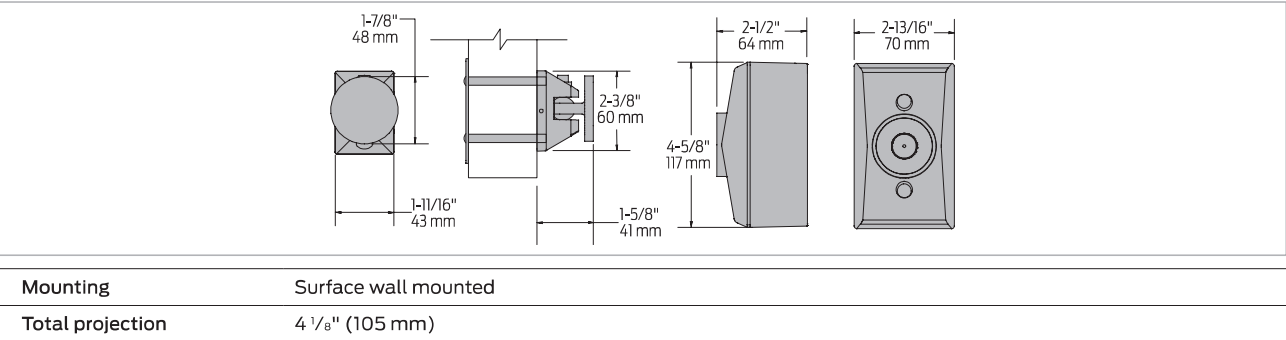

7840<sup>1</sup>

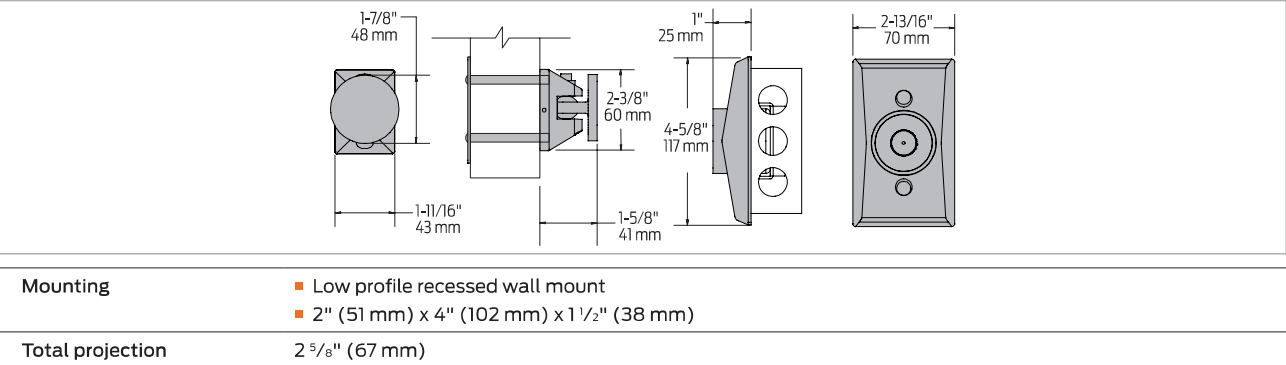

Note: Outlet box not included.

7850<sup>1</sup>

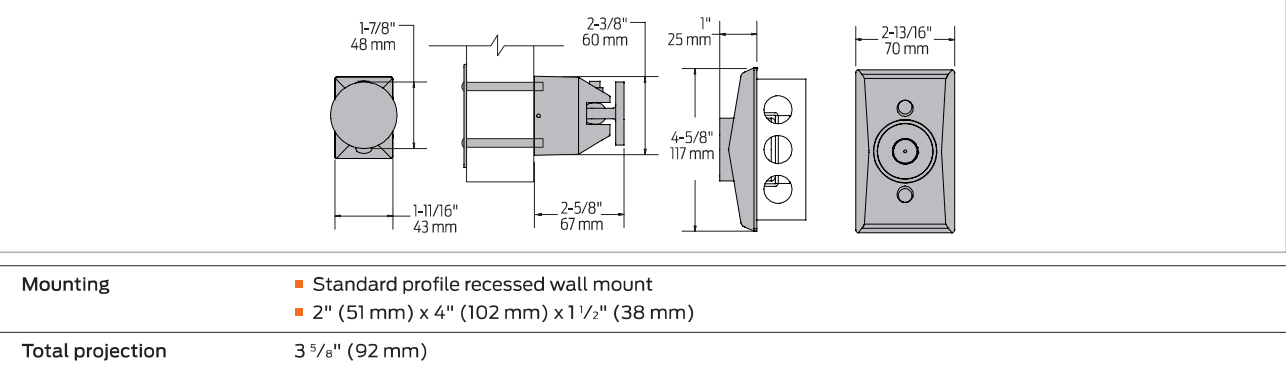

Note: Outlet box not included.

1. Suitable for use in pocket door installations.

Introduction	Product selection guide	SEM Series	3130SE Series	4040SE Series	2310ME Series	4310ME Series	4410ME Series	4310HSA Series	4410HSA Series	SEH Series
--------------	-------------------------	------------	---------------	---------------	---------------	---------------	---------------	----------------	----------------	------------

## Accessories

### Magnets



**SEM7820-516**  
**Magnet core assembly**

- Magnet coil
- Standard



**SEM7830(40)(50)-516**  
**Magnet core assembly**

- Magnet coil
- Standard

### Armatures



**SEM7820(30)(40)-825**  
**Door armature**

- Die cast low profile armature
- Standard



**SEM7850-828**  
**Door armature**

- Die cast armature
- Standard

Note: Fastener kits for mounting must be ordered separately using part numbers ending in-515.

### Fasteners

**SEM7820-515**  
**Fastener kit**

- Hex key wrench
- Armature thru hole plate and surface mount clip
- Cement anchor
- Wood and machine screws

**SEM7830-515**  
**Fastener kit**

- Hex key wrench
- Armature thru hole plate and surface mount clip
- Cement anchor
- Wood, machine and PHND screws

**SEM7840-515**  
**Fastener kit**

- Hex key wrench
- Armature thru hole plate and surface mount clip
- Cement anchor
- Wood, machine and PHND screws

**SEM7850-515**  
**Fastener kit**

- Hex key wrench
- Armature thru hole plate and surface mount clip
- Cement anchor
- Wood, machine and PHND screws

### Cover



**SEM7830(40)(50)-72**  
**Standard cover**

- Die cast cover
- Standard

### Box



**SEM7830-268**  
**Surface mount box**

- Die cast surface wall mount box
- Standard

### Extensions

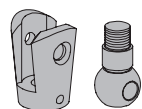

**SEM7810-514**  
**Ball pivot/connection link**

- Required for each door needing extension(s)
- Kit includes coupler link and ball pivot (alone serves as a 1 1/2" extension)



**SEM7810-E050**  
**Magnet extension 1/2"**

- Metal
- Standard



**SEM7810-E075**  
**Magnet extension 3/4"**

- Metal
- Standard



**SEM7810-E100**  
**Magnet extension 1"**

- Metal
- Standard



**SEM7810-E200**  
**Magnet extension 2"**

- Metal
- Standard



**Extension, SEM7810-E400**  
**Magnet extension 4"**

- Metal
- Standard

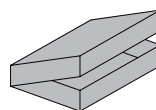

**SEM7810-517**  
**Magnet SEM extension kit**

- Extension kit includes:
- 10 .....7810SEM-E100
- 5 .....7810SEM-E200
- 10 .....7810SEM-E050
- 20 .....7810SEM-514
- 10 .....7810SEM-E075